



AMARILLO AREA PUBLIC HEALTH DISTRICT

Cities of Amarillo, Canyon, the Villages of Timbercreek Canyon, Lake Tanglewood,
Palisades, the Town of Bishop Hills, and Potter and Randall County
CITY OF AMARILLO, P. O. Box 1971, Amarillo, TX, 79105-1971

Environmental Health Food Establishment Permitting Checklist

Completed application for a Permit to Operate a Food Establishment.	Yes <input type="checkbox"/>	No <input type="checkbox"/>
Completed Food Establishment Plan Review Guide.	Yes <input type="checkbox"/>	No <input type="checkbox"/>
Proposed Menu	Yes <input type="checkbox"/>	No <input type="checkbox"/>
Equipment Schedule (or manufacture cut sheets) *	Yes <input type="checkbox"/>	No <input type="checkbox"/>
Site Plan (showing all dimensions) *	Yes <input type="checkbox"/>	No <input type="checkbox"/>
Floor Plan (drawn to scale) *	Yes <input type="checkbox"/>	No <input type="checkbox"/>

* If Equipment Schedule, Site Plan and Floor Plans are not included in application they must have been submitted through Development Services and verified by an Environmental Health Specialist that there is a copy of these either on the "Q Drive" or on a "Micro Fiche".

Q Drive:

Micro Fiche

EH Specialist Signature: _____ Date: _____

These submittal documents have been received and verified by:

Administrative Specialist: _____ Date: _____

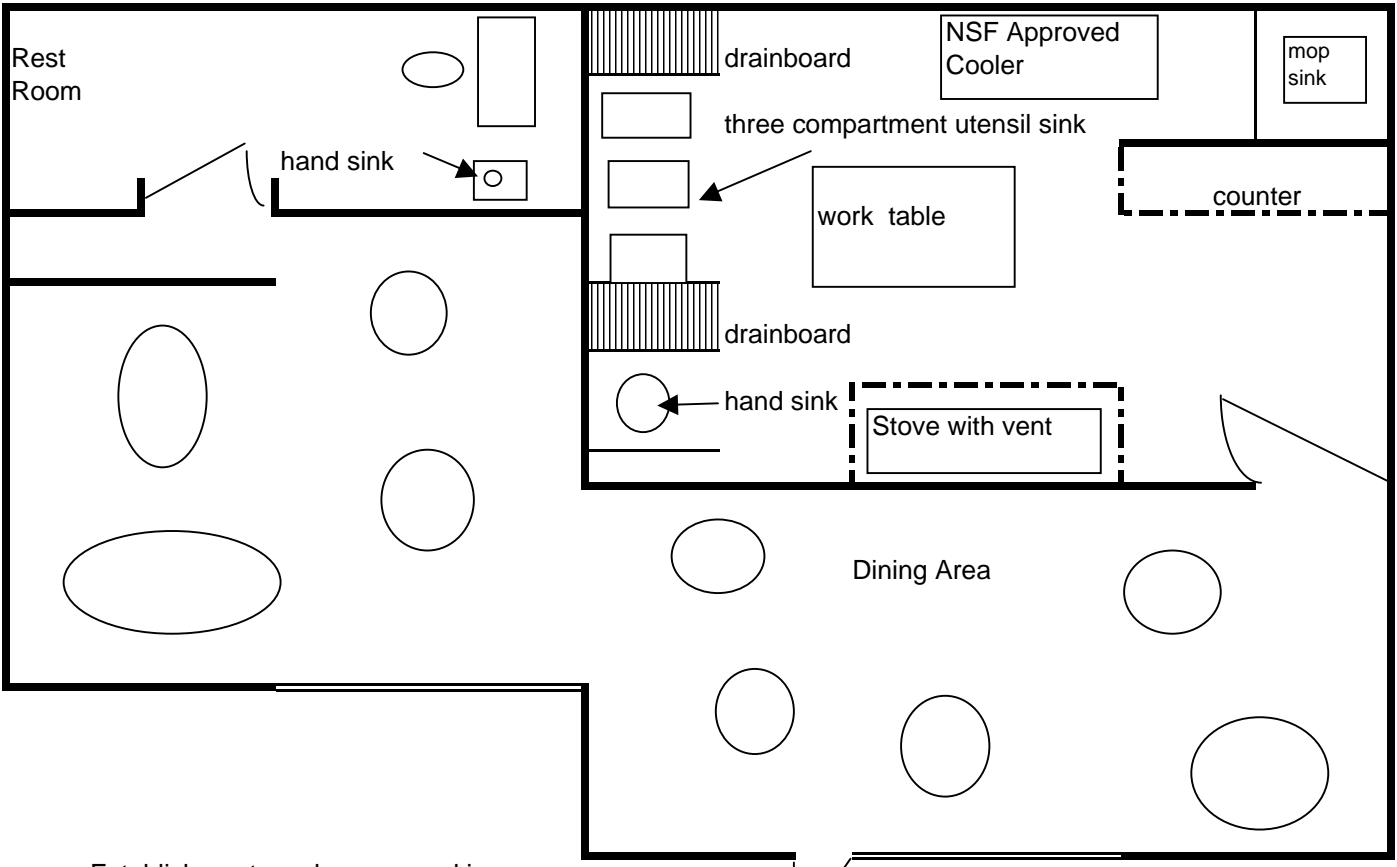

Establishment can be non smoking
If smoking allowed, must designate
areas for non smoking

Plot Plan

