

THE CITY OF AMARILLO, TEXAS

INTERDEPARTMENTAL OFFICE COMMUNICATION

September 8, 2011

TO: Final Distribution

FROM: Planning Department

SUBJECT: P-11-46 Original Town of Amarillo Unit No. 11, an addition to the City of Amarillo, being a replat of Lots 13 thru 24, Block 38, Original Town of Amarillo, in Section 188, Block 2, AB&M Survey, Potter County, Texas. (Vicinity: Bonham St. & SW 5th Ave.)
DEVELOPER: Chris Culp & Matt Brewton

The Designated Official for the City of Amarillo approved the above-mentioned item on August 3, 2011. The plat was filed of record in the Official Public Records of Potter County in Volume 4342, Page 662 on August 5, 2011. Please post your records accordingly.



Kelley Shaw, Planning Director

BLK 2 AB + M

SEC 188

08-05-11

2000 CENSUS TRACT # 120 A.P. M-11

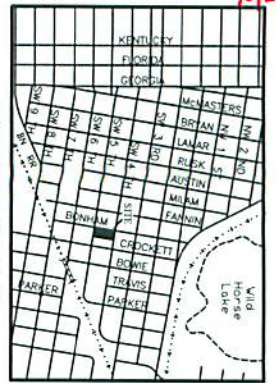

NOTES
1) THIS PLAT IS WITHIN THE AMARILLO CITY LIMITS
2) THIS PLAT DOES NOT LIE WITHIN A FLOOD HAZARD ZONE ACCORDING TO THE FEDERAL FLOOD INSURANCE RATE MAP COMMUNITY PANEL NO. 487260590C, DATED JUNE 4, 2010, OR WITHIN THE CITY OF AMARILLO BASE FLOOD ACCORDING TO FLOOD DAMAGE MITIGATION CHAPTER OF THE MUNICIPAL CODE. USE OF F.L.R.M. MAPS MUST NOT BE CONSTRUED AS A SPECIFIC SITE FLOOD ELEVATION BY THIS SURVEYOR.

FILED OF RECORD **8-5-11** (DATE)
4342 (VOLUME)
GRANTEE'S ADDRESS
CITY OF AMARILLO
P.O. BOX 1971
AMARILLO, TEXAS 79105-1971

Potter (COUNTY)
Lot 13A (PAGE)

NAD 83 - TEXAS NORTH
NORTHING: 1134066.021 METERS
EASTING: 1099111.33 METERS
SCALE FACTOR: 0.99997172

BONHAM STREET
AMARILLO, TEXAS
60' R.O.W. (VOL. 65, P.C. 18)

APPROVED BY VICKI COVEY, DESIGNATED OFFICIAL FOR THE CITY OF AMARILLO
TEKAS VICKI COVEY DAY OF August 2011
VICKI COVEY



JEANNA L LILEY
Notary Public
State of Texas
My Comm. Exp. 01-11-2012

FURMAN LAND SURVEYORS, INC.
DANIEL R. FURMAN, PRS.
DONALD W. FURMAN, PRS.
BEATRICE LYNN LEMONS, PRS.
LAWSON M. STOKES, PRS.
P.O. BOX 1416
AMARILLO, TX 79105
PHONE NO. 817-282-6633
FAX NO. 817-282-6634
DMAIL: TEXAS79029@FURMANLANDSURVEYORS.COM
PROJECT NO. 1112282 FILE NO. M-11
DRAWING NO. CVSUB11\9077282\M-11\1112282

ATTEST

LOT 1	60'
LOT 2	60'
LOT 3	60'
LOT 4	60'
LOT 5	60'
LOT 6	60'
LOT 7	60'
LOT 8	60'
LOT 9	60'
LOT 10	60'
LOT 11	60'
LOT 12	60'

ATTEST
THE STATE OF TEXAS
COUNTY OF Potter
I, Randaug, Notary Public for the State of Texas, do hereby certify that this instrument was acknowledged before me by Matt Brewton on this 29th day of July, 2011.

ATTEST
THE STATE OF TEXAS
COUNTY OF Potter
I, Randaug, Notary Public for the State of Texas, do hereby certify that this instrument was acknowledged before me by Matt Brewton on this 29th day of July, 2011.

OWNERS ACKNOWLEDGEMENT
THE STATE OF TEXAS
COUNTY OF POTTER
KNOW ALL MEN BY THESE PRESENTS
THAT THE UNDERSIGNED, KCMB PROPERTIES CORP., THE PRESENT OWNERS OF THE LAND SHOWN AND DESCRIBED ON THIS MAP AND PLAT HAVE CAUSED ALL OF SAID LANDS TO BE SURVEYED, SUBDIVIDED, PLATTED, AND DESIGNATED AS ORIGINAL TOWN OF AMARILLO UNIT NO. 11, AN ADDITION TO THE CITY OF AMARILLO, TEXAS AND SO DECLARE THAT ALL OF THE EASEMENTS SHOWN UPON SUCH MAP AND PLAT ARE DEDICATED TO THE PUBLIC FOREVER TO BE USED AS SUCH.
EXECUTED THIS 29th DAY OF July, 2011
R. Liley
KCMB PROPERTIES CORP.
KRIS CULP - OWNER
400 CEDAR MEADOW CIRCLE
AMARILLO, TEXAS 79124
M.B.R.
KCMB PROPERTIES CORP.
MATT BREWTON - OWNER
400 CEDAR MEADOW CIRCLE
AMARILLO, TEXAS 79124

Issued By:
POTTER COUNTY TAX OFFICE
PO BOX 2289
AMARILLO, TX 79105-2289

Property Information	
Property ID: 24636	Geo ID: 5601002715
Legal Acres: 0.0000	
Legal Desc: ORIG TOWN OF AMA LOT	BLOCK 0038 13 THRU 24
Situs: S BONHAM ST	AMARILLO, TX
DBA:	
Exemptions:	

VOL 4342 PAGE 661

Owner ID: 100094561 100.00%
KCMB PROPERTIES CORP
400 CEDAR MEADOW CIR
AMARILLO, TX 79124-1425

For Entities	Value Information
AMA COLLEGE	Improvement HS: 0
AMARILLO	Improvement NHS: 3,466
AMARILLO ISD	Land HS: 0
PANHANDLE WD	Land NHS: 24,150
POTTER COUNTY	Productivity Market: 0
	Productivity Use: 0
	Assessed Value 27,616

Current/Delinquent Taxes
This document is to certify, that after a careful check of the tax records of this office, the following current or delinquent taxes, penalties, and interest are due on the property for the taxing entities described above.

Year	Entity	Taxable	Tax Due	Disc./P&I	Attorney Fee	Total Due
Totals:			0.00	0.00	0.00	0.00
Effective Date: 07/22/2011			Total Due if paid by: 07/31/2011			0.00

Tax Certificate Issued for:	Taxes Paid in 2010
POTTER COUNTY	165.45
AMARILLO	85.64
PANHANDLE WD	2.46
AMA COLLEGE	52.46
AMARILLO ISD	323.10

THE TAXES TO BE IMPOSED BY THE ABOVE LISTED TAXING UNITS FOR THE 2011 TAXES HAVE NOT BEEN CALCULATED.

If applicable, the above described property is receiving special valuation based on its use. Additional rollback taxes which may become due based on the provisions of the special valuation are not indicated in this document.

This certificate does not clear abuse of granted exemptions as defined in Section 11.43 Paragraph(1) of the Texas Property Tax Code.

May Be Subject to Court Costs if Suit is Pending

Date of Issue: 07/22/2011
Requested By: KCMB PROPERTIES CORP
Fee Amount: 10.00
Reference #:

Signature of Authorized Officer of Collecting Office

Filed AND Recorded
OFFICIAL PUBLIC RECORDS
On: Aug 05, 2011 at 08:45A

Receipt# - 160797

Document Number 01200273:

Amount 20.00

Julie Smith
County Clerk, Potter County

by  Deputy

RETURN TO:

CITY OF AMARILLO
PLANNING DEPARTMENT
P.O. BOX 1971
AMARILLO, TEXAS 79101

STATE OF TEXAS COUNTY OF POTTER
I hereby certify that this instrument was
FILED on this date and at this time stamped
hereon by me and was duly RECORDED in the
OFFICIAL PUBLIC RECORDS OF POTTER COUNTY TEXAS,
in the volume and page as shown.

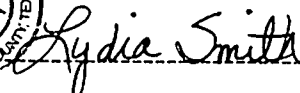

Julie Smith, County Clerk
Potter County

 Deputy

Any provision herein which restricts the sale,
rental or use of the described real property
because of color or race is invalid and
unenforceable under federal law.

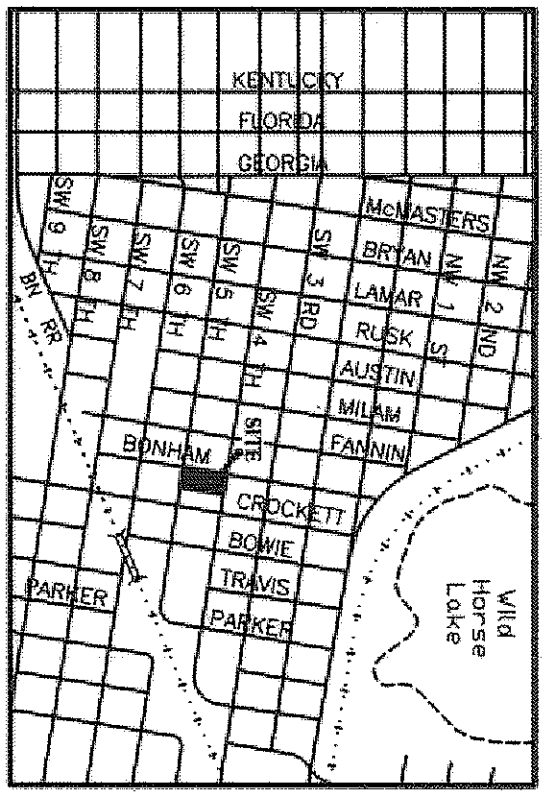

VICINITY MAP
NOT TO SCALE

- LEGEND:**
- 1/2" IRON ROD W/ CAP PND
 - 1/2" IRON ROD W/ CAP PND
 - * 2" IRON PIPE END
 - EASEMENT
 - ADDRESS PROVIDED BY CITY OF AMARILLO SUBJECT TO CHANGE WITHOUT NOTICE
 - R.O.W.
 - RIGHT-OF-WAY

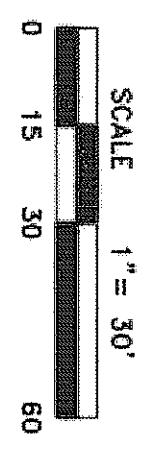
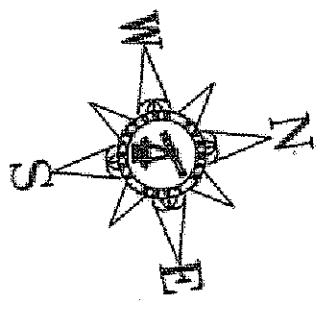

NOTES:

- 1) THIS PLAT IS WITHIN THE AMARILLO CITY LIMITS.
- 2) THIS PLAT DOES NOT LIE WITHIN A FLOOD HAZARD ZONE ACCORDING TO THE FEDERAL FLOOD INSURANCE RATE MAP COMMUNITY PANEL NO. 48375C0393C, DATED JUNE 4, 2010, OR WITHIN THE CITY OF AMARILLO BASE FLOOD ACCORDING TO FLOOD DAMAGE MITIGATION CHAPTER OF THE MUNICIPAL CODE. USE OF F.I.R.M. MAPS MUST NOT BE CONSTRUED AS A SPECIFIC SITE FLOOD ELEVATION BY THIS SURVEYOR.

FILED OF RECORD
 DATE: 8/5/11
 COUNTY: Potter
 (VOLUME): 4342
 (PAGE): 660

GRANTEES ADDRESS:
 CITY OF AMARILLO
 P.O. BOX 1971
 AMARILLO, TEXAS 79105-1971

FANNIN STREET
 (MEAS. S 80°27'15" E 328.33')
 ALLEY
 N.A.D. 83 - TEXAS NORTH
 NORTHING: 1134560.022 METERS
 EASTING: 167455.149 METERS
 SCALE FACTOR: 0.99991727

BONHAM STREET
 AMARILLO, TEXAS

80' R.O.W. (VOL. 65, PG. 18)
 BASE LINE
 N 09°30'00" E 300.00'

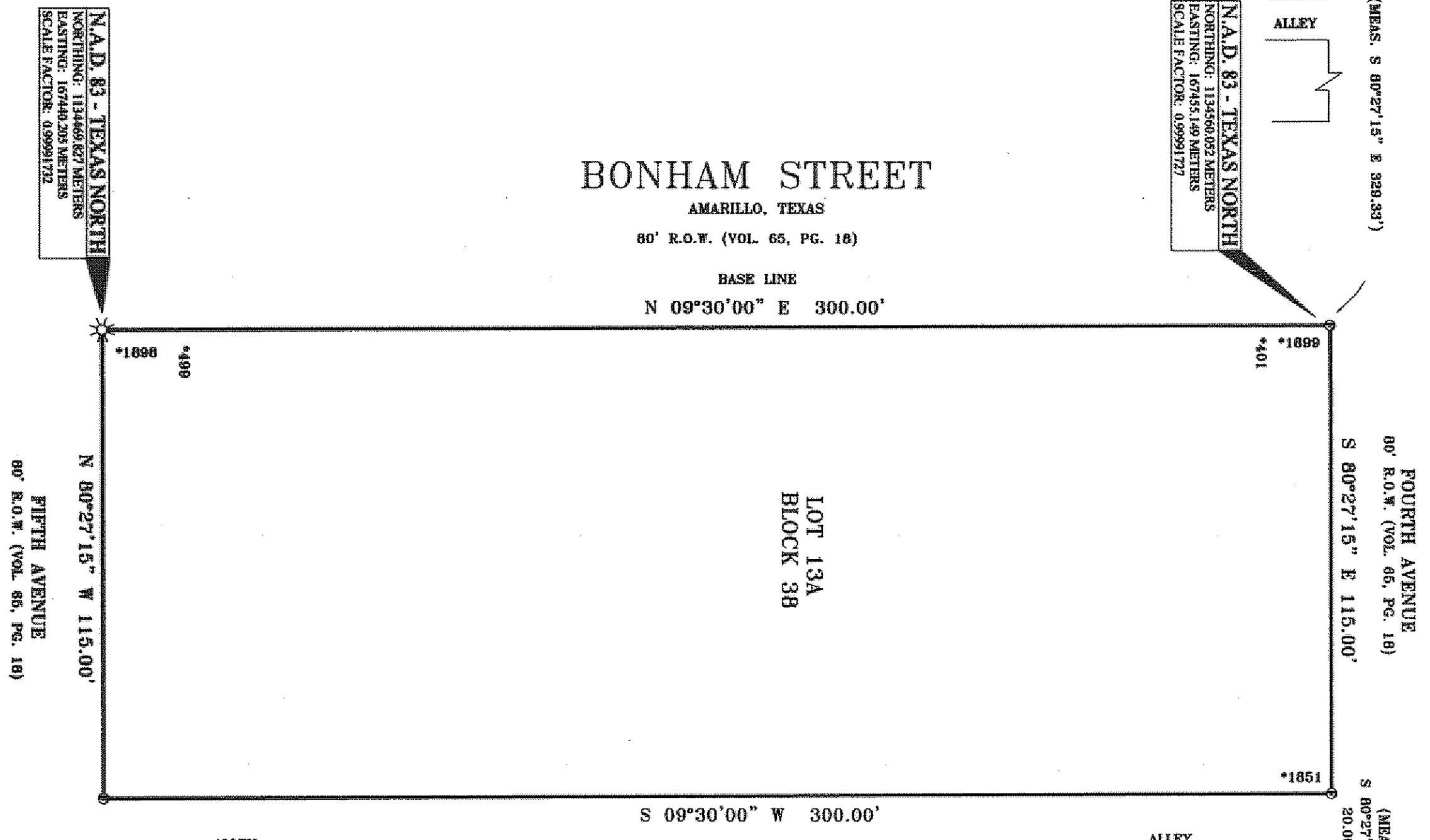

LOT 1	LOT 2	LOT 3	LOT 4	LOT 5	LOT 6	LOT 7	LOT 8	LOT 9	LOT 10	LOT 11	LOT 12
-------	-------	-------	-------	-------	-------	-------	-------	-------	--------	--------	--------

DESCRIPTION
 All of Lots 13 thru 24, Block 38, Original Town of Amarillo, Potter County, Texas, according to the map or plat thereof, recorded in Volume 65, Page 18 of the Deed Records of Potter County, Texas.

OWNERS ACKNOWLEDGEMENT
 THE STATE OF TEXAS
 COUNTY OF POTTER
 KNOW ALL MEN BY THESE PRESENTS
 THAT THE UNDERSIGNED, KCMB PROPERTIES CORP., THE PRESENT OWNERS OF THE LAND SHOWN AND DESCRIBED ON THIS MAP AND PLAT HAVE CAUSED ALL OF SAID LANDS TO BE SURVEYED, SUBDIVIDED, PLATTED, AND DESIGNATED AS ORIGINAL TOWN OF AMARILLO UNIT NO. 11, AN ADDITION TO THE CITY OF AMARILLO, TEXAS AND SO DECLARE THAT ALL OF THE EASEMENTS SHOWN UPON SUCH MAP AND PLAT ARE DEDICATED TO THE PUBLIC FOREVER TO BE USED AS SUCH.
 EXECUTED THIS 29th DAY OF July, 2011.

[Signature]
 KCMB PROPERTIES CORP.
 KRIS CULP - OWNER
 400 CEDAR MEADOW CIRCLE
 AMARILLO, TEXAS 79124

[Signature]
 KCMB PROPERTIES CORP.
 MATT BREWTON - OWNER
 400 CEDAR MEADOW CIRCLE
 AMARILLO, TEXAS 79124

ATTEST
 THE STATE OF TEXAS
 COUNTY OF Potter
 THIS INSTRUMENT WAS ACKNOWLEDGED BEFORE ME BY KRIS CULP, 29th DAY OF July, 2011.
[Signature]
 JENNAL LILLEY
 NOTARY PUBLIC, STATE OF TEXAS

ATTEST
 THE STATE OF TEXAS
 COUNTY OF Potter
 THIS INSTRUMENT WAS ACKNOWLEDGED BEFORE ME BY MATT BREWTON, 29th DAY OF July, 2011.
[Signature]
 JENNAL LILLEY
 NOTARY PUBLIC, STATE OF TEXAS

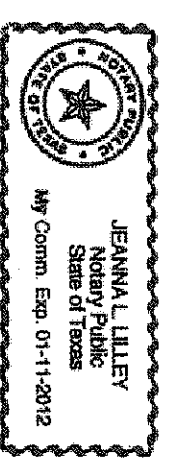
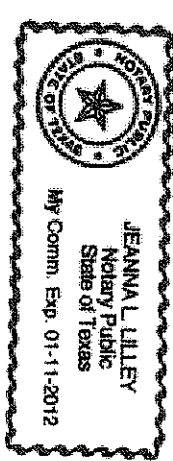

CERTIFICATE

I, DO HEREBY CERTIFY THAT THIS PLAT IS TRUE AND CORRECT TO THE BEST OF MY KNOWLEDGE AND BELIEF; THAT IT WAS PREPARED FROM A PERIMETER SURVEY MADE ON THE GROUND BY ME OR BY OTHERS UNDER MY DIRECT SUPERVISION WITH MONUMENTS, SET OR FOUND AS INDICATED, AT ALL CORNER CORNERS ON THIS 26TH DAY OF APRIL, 2011.

AN ADDITION TO
 THE CITY OF AMARILLO
 BEING A REPLAT OF LOTS 13 THRU 24,
 BLOCK 38, ORIGINAL TOWN OF AMARILLO,
 IN SECTION 188, BLOCK 2,
 A.B. & M. SURVEY,
 POTTER COUNTY, TEXAS
 0.79± ACRE

**ORIGINAL TOWN
 OF AMARILLO
 UNIT NO. 11**

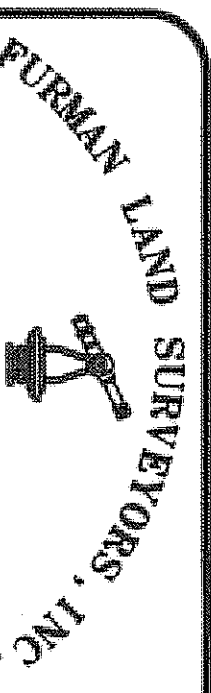

FURMAN LAND SURVEYORS, INC.
 DANIEL E. FURMAN, RPLS
 DONALD E. FURMAN, RPLS
 HEATHER LYNN LEMONS, RPLS
 LAMBORN E. STOKES, RPLS
 CASSEY A. HARRIS, RPLS
 (806) 374-4255
 P.O. BOX 1416
 AMARILLO, TX 79105
 (806) 394-1455
 P.O. BOX 484
 DUMAS, TEXAS 79029

[Signature]
 HEATHER LYNN LEMONS R.P.L.S. 5712
 REGISTERED PROFESSIONAL LAND SURVEYOR

PROJECT NO. 1112282 FILE NO. M-11
 DRAWING NO. C-SUB111/POTTER/M-11/1112282